

Top Hung Window

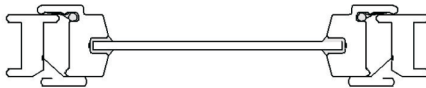
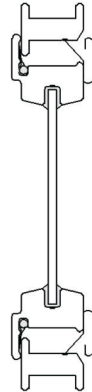
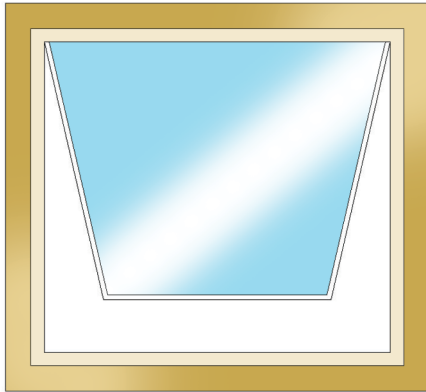

Top hung windows are fabricated from roll formed sections made of galvanized colour coated steel with a combination of specially designed components made up of crca with zinc phosphate, nylon or high grade aluminum with powder coating. Section to section overlap, the gasket around glass and between frame & shutter are designed to give perfect sealing.

Specification

Providing and fixing **Top Hung Windows**, fabricated from roll formed sections made of Galvanized Steel Colour Coated/ Powder Coated (Base Steel as per IS 513 "D" quality, Galvanized as per IS 277 with Zinc of 120 grams/ Sq. Mtr.) with total coated thickness of 0.58mm.

Paint Specification

Coated Sections should be with Primer Coat of Epoxy Primer of 5-7 microns thick, finish painted with a Polyester Paint of 12-16 microns thick and back coated with Alkyd backer of 5-7 microns, OR Powder Coated with pure Polyester Powder up to 50-60 microns thick.

Dimensions of Sections

Section for outer frame should be 46mm x 52mm x 0.58mm thickness, section for mullion should be 46mm x 70mm x 0.58mm thickness, section for shutter should be 46mm x 46mm x 0.58mm thickness and section for beading should be 18mm x 25mm x 0.58mm thickness.

Glass

Glazed Shutter and Fixed Glass portions should be provided with Pinhead glass of 3.5mm.

Assembling & Installation

The Frame & Shutter Sections should be cut to length and mitre joined with Corner Bracket made of Nylon. Mullion Section should be joined with Frame/ Mullion using Nylon / PPCB Mullion Cap. Ethyl Propylene Diamine Monomer (EPDM) Gasket should be used all around glass in shutter and between frame and glazed shutter and both sides of fixed glass. Window Frame should be fixed to brick/ concrete masonry by using Nylon self-expanding sleeves and driving MS electroplated 80mm long screws into the sleeves through the frames.

DETAIL 101

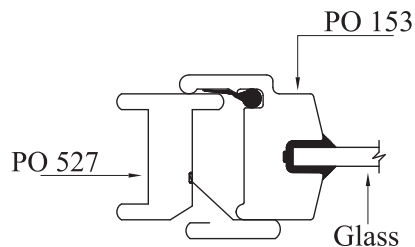

Operatable Louver

Adjustable louver Windows / Ventilators are fabricated from roll formed sections made of galvanized colour coated steel with a combination of specially designed components made up with nylon. These louvers are adjustable to control light and air. These are ideally suited for Bath Rooms and Kitchens.

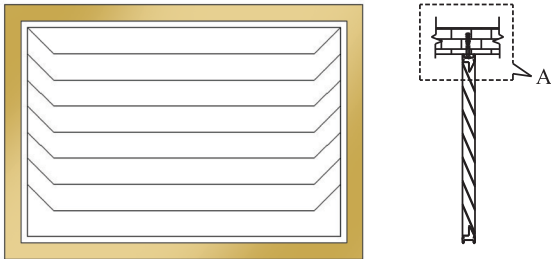

Specification

Providing and fixing Windows, fabricated from roll formed sections made of Galvanized Steel Colour Coated/ Powder Coated (Base Steel as per IS 513 "D" quality, Galvanized as per IS 277 with Zinc of 120 grams/ Sq. Mtr.) with total coated thickness of 0.58mm.

Paint specifications

Coated Sections should be with Primer Coat of Epoxy Primer of 5-7 microns thick, finish painted with a Polyester Paint of 12-16 microns thick and back coated with Alkyd backer of 5-7 microns, OR Powder Coated with pure Polyester Powder up to 50-60 microns thick.

Accessories

Glass holding flanges made of glass filled nylon. Handle made of nylon. Connecting Rod made of M.S. plate.

Glass

Louvered Glass should be provided with Pinhead glass of 3.5mm.

Assembling & Installation

The Frame Sections should be cut to length and mitre joined with Corner Bracket made of Nylon. Window Frame should be fixed to brick/ concrete masonry by using Nylon self-expanding sleeves and driving MS electroplated 80mm long screws into the sleeves through the frames.

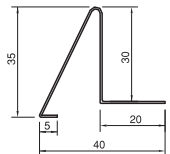

PO 193 A

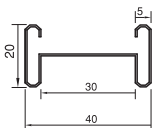

PO 193

WALL FIXING CAP & SCREW

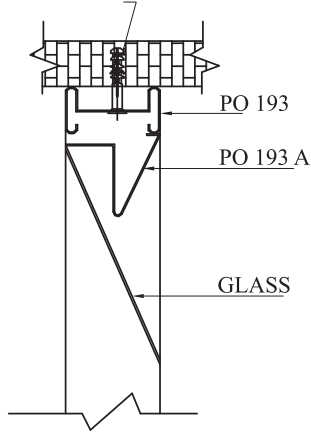

DETAIL 'A'

FIXED LOUVER VENTILATOR

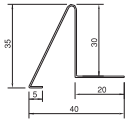
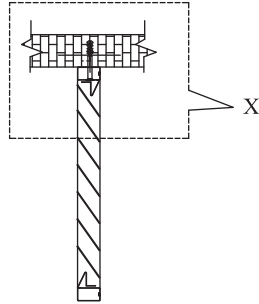
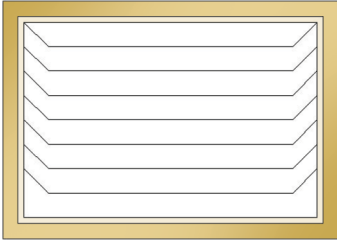

PO 193 A

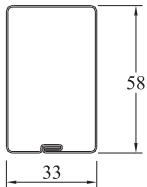

33 x 58 box section

WALL FIXING CAP & SCREW

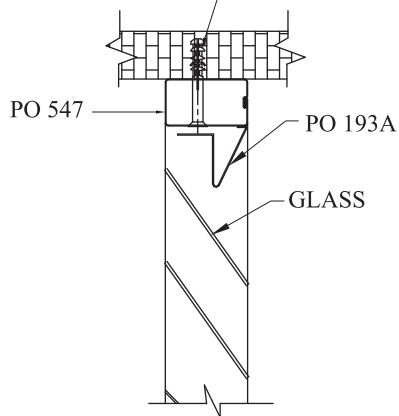

DETAIL 'X'

Fixed Louver Ventilator is fabricated from roll formed sections made of galvanized colour coated steel with a combination of specially designed components made of Nylon / Polypropylene. These are ideally suitable for Bath Rooms and Kitchens.

Specification

Providing and Fixing Fixed Louver Ventilator fabricated from Roll formed sections made of galvanized Steel colour coated/powder coated (Base Steel as per IS 153 'D' quality, galvanized as per IS 277 with zinc of 120 grams/Sq.Mtr) with total coated thickness of 0.58mm.

Paint specifications

Coated Sections should be with Primer Coat of Epoxy Primer of 5-7 microns thick, finish painted with a Polyester Paint of 12-16 microns thick and back coated with Alkyd backer of 5-7 microns, OR Powder Coated with pure Polyester Powder up to 50-60 microns thick.

Dimensions of Sections

The section for external frame should be of 33 x 58 mm.

Accessories

Glass holding flanges made of polypropylene.

Assembling & Installation

The Frame Sections should be cut to length and mitre joined with Corner Bracket made of Nylon. Window Frame should be fixed to brick/ concrete masonry by using Nylon self-expanding sleeves and driving MS electroplated 80mm long screws into the sleeves through the frames.